



ENGEL JACOBS
LONDON+HERTS



- Newly Refurbished
- Brand New Kitchen
- High Ceilings
- Two Bedrooms
- Communal Garden
- Close to West Hampstead High Street & Great Transport Links



Honeybourne Road
London

Monthly Rental Of
£2,400

Entrance Hall

Radiator, entry phone.

Bedroom 1 14' 0" x 13' 9" (4.26m x 4.19m)

Carpeted throughout, windows to front aspect, radiator.

Bedroom 2 14' 0" x 13' 9" (4.26m x 4.19m)

Carpeted throughout, fully fitted wardrobe, windows to rear aspect, radiator.

Bathroom

Tiled floor, partly tiled walls, low level WC, wash basin with mixer tap and storage beneath, bath with overhead shower, heated towel rail, obscured window to side aspect.

Kitchen 10' 9" x 10' 7" (3.27m x 3.22m)

Fully fitted units both wall mounted and base, ample work surface area, integrated Bosch fridge, integrated Bosch slimline dishwasher, Bosch oven and induction hob, AEG washer/dryer, windows to side aspect.

Reception 10' 9" x 8' 5" (3.27m x 2.56m)

Radiator, windows to rear aspect.

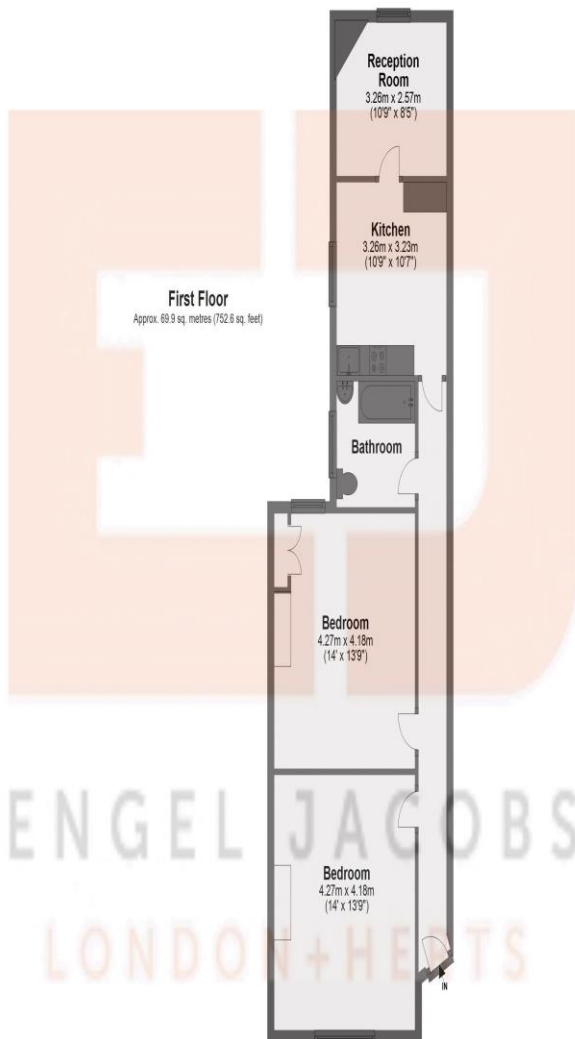

Total area: approx. 69.9 sq. metres (752.6 sq. feet)

Energy Efficiency Rating		Current	Potential
Very energy efficient - lower running costs			
(92-100)	A		
(81-91)	B		
(69-80)	C		80
(55-68)	D	67	
(39-54)	E		
(21-38)	F		
(1-20)	G		
Not energy efficient - higher running costs			
England, Scotland & Wales		EU Directive 2002/91/EC	

Address:

Yale Court, Honeybourne, Oxford

MONEY LAUNDERING REGULATIONS 2003

intending purchasers will be asked to produce identification and proof of financial status when an offer is received. We would ask for your co-operation in order that there will be no delay in agreeing the sale.